



# POLYTEC FOR FOUNDRIES

Polytec brings decades of expertise in steelmaking robotics to the **foundry sector**, applying its know-how to solutions that raise safety standards, increase efficiency, and improve process reliability.

Several foundry-related tasks can be automated, including:

- Temperature and sampling
- Automatic scale cleaning
- Automated molten metal sampling
- Molten metal surface skimming

ITALY | USA | BRAZIL | MEXICO | SOUTH KOREA

[sales@bmgroup.com](mailto:sales@bmgroup.com)

[www.polytecmechatronics.com](http://www.polytecmechatronics.com)





## PolySAMPLE

### *Temperature and sampling robot*

- Adaptable measurement depth inside the molten metal bath
- Axis temperature monitoring and air cooling system
- VPN remote access and maintenance
- User-friendly HMI interface
- Automatic cartridge loading and unloading
- Automatic tool change

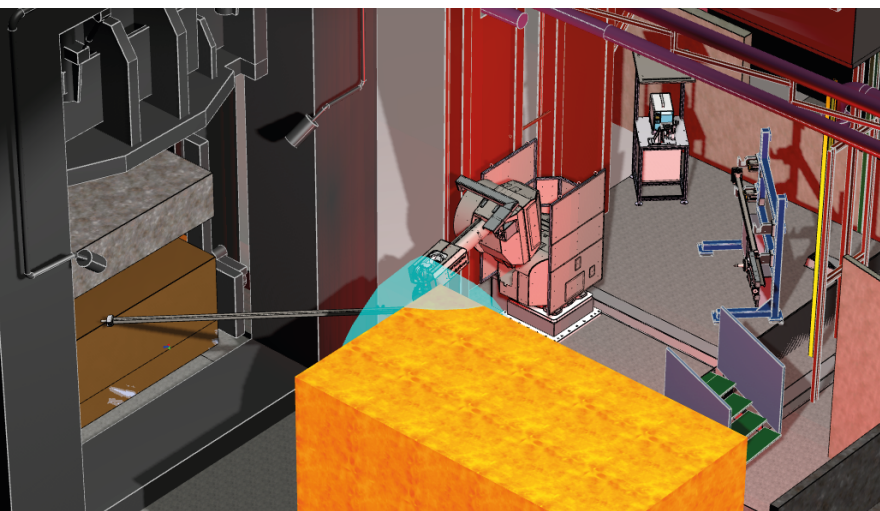
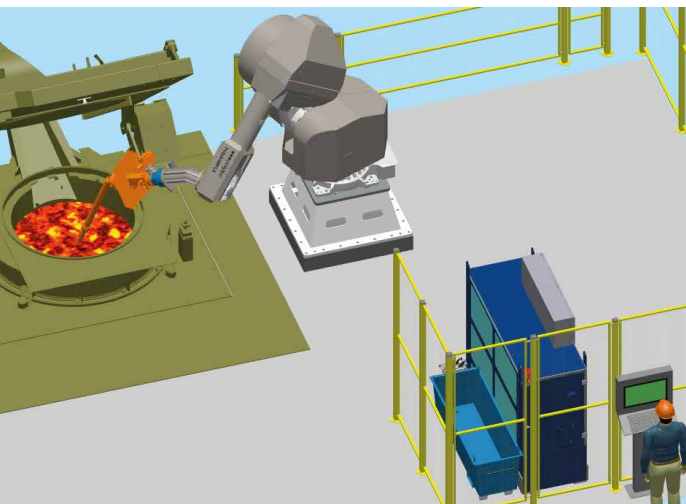

## PolyDESCALING

### *Automatic scale cleaning system*

- Cleaning of the work surface from processing residues
- Hot product dimensional check
- Hot product tagging system
- Automatic tool change
- VPN remote access and maintenance
- User-friendly HMI interface





## PolySAMPLE S

### *Robotic molten metal sampling system*

- Molten metal sample collection
- Sampling with volumetric control
- Pouring into mold and thermal analysis cup
- Thermal analysis curve

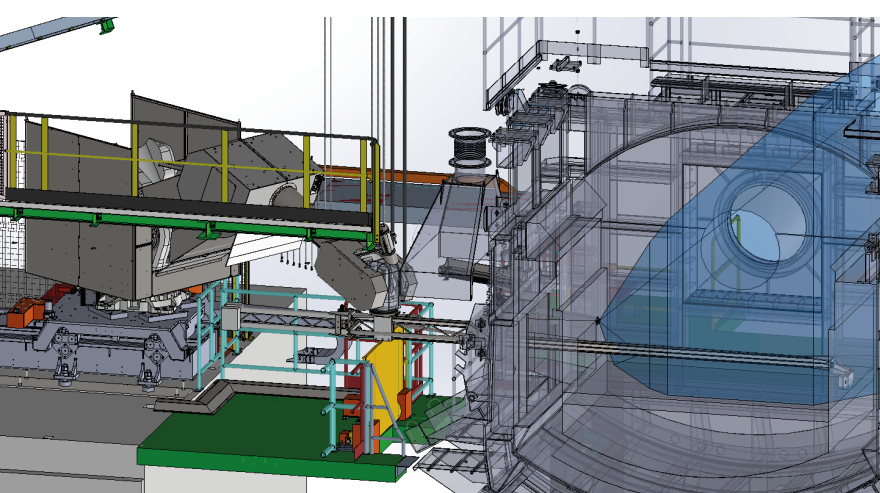
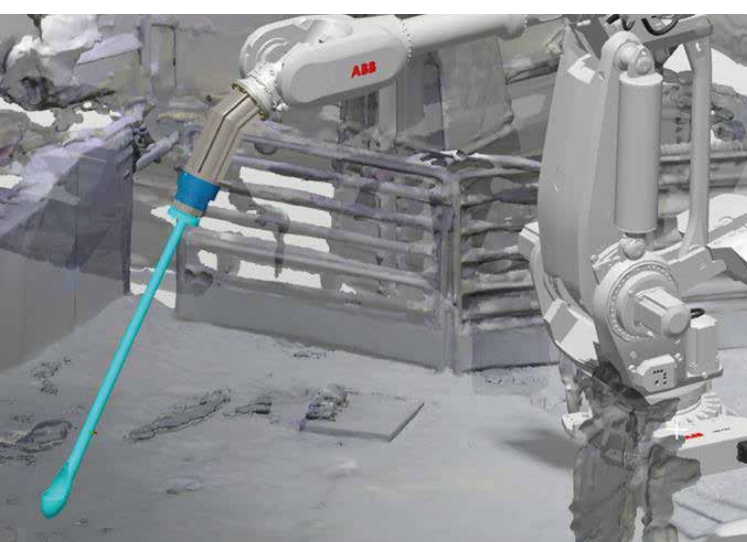

## PolySKIM

### *Automatic robot for molten metal surface skimming*

- Dross bucket level identification
- Axis temperature monitoring
- Stainless steel protective carter
- VPN remote access and maintenance
- User-friendly HMI interface





## PROFILE

Polytec is an Italian company that has been developing **automation** and **robotic solutions** for critical industrial processes for over 30 years.

## COMPETENCES

Polytec's is structured with electrical engineering, automation, and mechatronics departments, including an internal software house.

### SAFETY

- Reduced exposure to the red zone and improved ergonomics
- No operators in high-risk areas

### PRODUCTIVITY

- Repeatability
- Measurable process time
- Downtimes reduction
- Predictive maintenance

### QUALITY

- Process and product traceability
- Product certifiability

## ELECTRICAL AND AUTOMATION SYSTEMS

1. Electrical engineering
2. Automation panels
3. Distribution boards
4. Customized on-board machine
5. Industrial control software
6. Product and production tracking platforms
7. Technological packages
8. Service and After Sales

## BEST SELLER ROBOTICS APPLICATIONS

- Temperature and sampling
- Skimming and cleaning
- Marking and tagging
- Handling and palletizing
- Welding and descaling
- Tailor-made mechatronic projects

Our extensive **global** network and presence ensure rapid and reliable **support** worldwide, with locations in Brazil, Mexico, the USA, and South Korea.

